



MEDIUM EDUCATION PERFORMANCE SPACE

Application Guide



Medium Education Performance Space

- Dedicated space for productions and presentations
- 300 - 2000 Seats
- Focused on teaching
- Secondary or higher education
- Plays, music performances, guest speakers, and more
- Run by teachers, students, or volunteers

Challenge

Solution

Medium education performance spaces are dedicated auditoriums built to easily facilitate varying types of productions. The lighting system in these spaces should have the capabilities to ensure the students shine on or off stage.



Vari-Lite offers an end-to-end solution for productions in a mid-sized education space, making it easy to get the perfect look. For non-performance use, Vision.Net and Button Stations offer a simple way of controlling the entire system without the need for a full-featured console.

From the technical perspective, the theatrical lighting system in a mid-sized school theatre requires a quality lighting solution that is cost-effective, scalable and fully featured, providing the maximum impact on a limited budget.



To provide adaptable and easy-to-use lighting for education theatres, Vari-Lite's luminaires and control solutions offer a robust feature set at an affordable price, ensuring the students can learn in a fun and semi-professional environment.

Medium-sized school theatres are all about balance, designed to entertain in a teaching environment. This enables students to learn and build creative and technical confidence while having fun, fostering the education of technical and creative performance art.



VL1600 Profile and Acclaim LED Series fixtures introduce students to the full breadth of different types of theatrical luminaires. Adding a FLX or Neo C10 lighting console makes it easy for young techs to improve their skills, balancing professional capabilities with a simple, intuitive interface.

Schools need to maximize return on investment, so the lighting system should be easily maintained so that it works over an extended period. This allows instructors to educate students on the fundamentals of how to operate the technology correctly and safely for years.

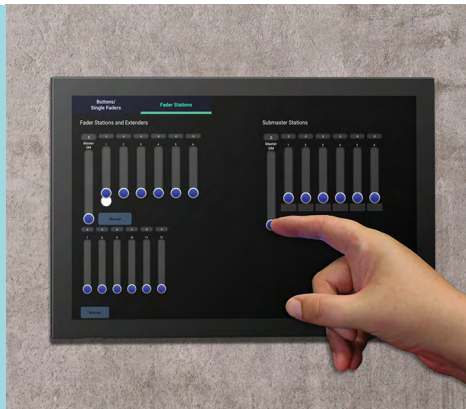

For everyday events, the Vision.Net Touchscreen is as comfortable as your personal tablet. Room lighting can be simply turned on and off, stage lighting looks can be recalled, and basic adjustments made effortlessly with the push of your finger.

LUMINAIRES

- **VL1600 Profile (x4)** - precision high-output profile luminaire designed for theatre and studio.
- **Acclaim LED 25° - 50° Zoomspot (x12)** - full color profile with integrated manual zoom and focus.
- **Acclaim LED PLE WW (x18)** - a fixed white 3200k LED light engine with fixed and zoom lens tube options.
- **Acclaim LED Fresnel (x9)** - true full color theatrical Fresnel wash with manual zoom and 4-leaf barn door.
- **Acclaim LED Cyc (x6)** - full color cyclorama fixture designed for small to medium-sized spaces.

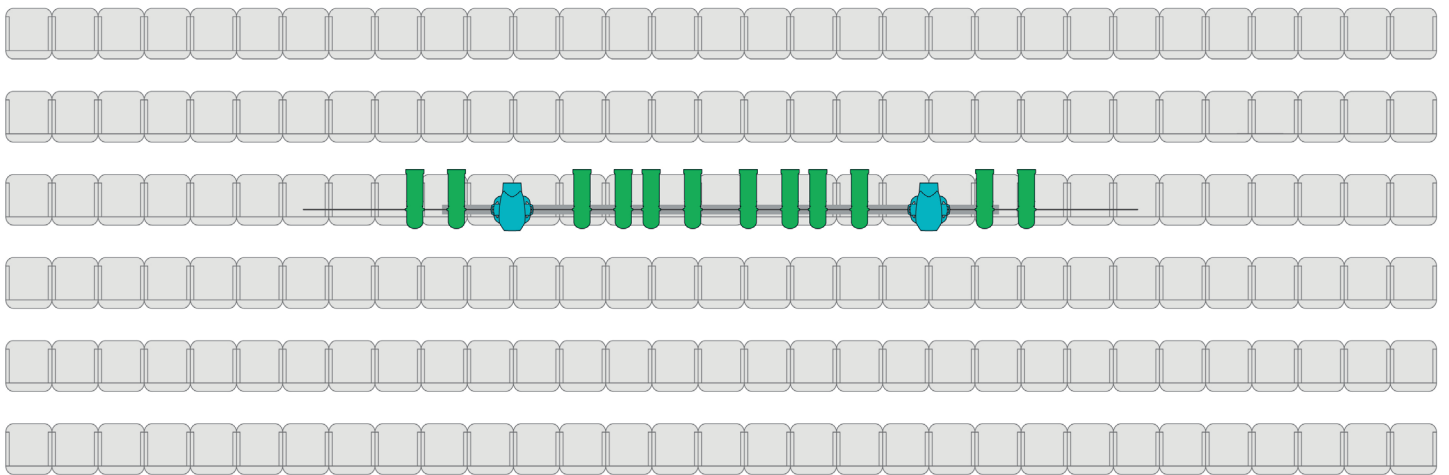
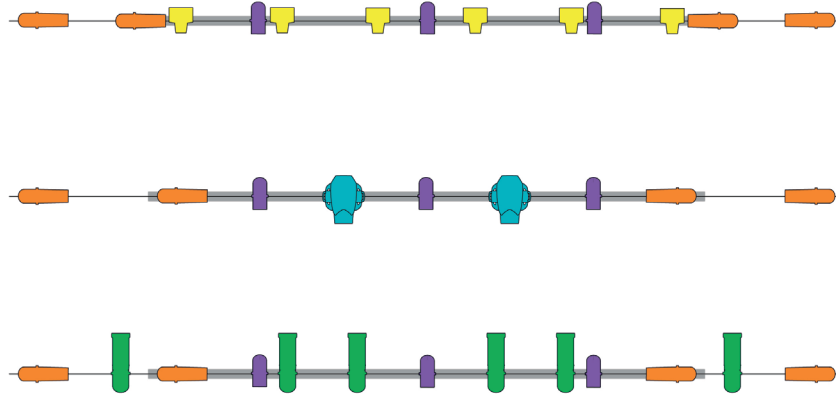

CONNECTIVITY (120V)

Neo C10 Console (x 1) - powerful, yet compact lighting console with command line programming.

Vision.Net 10.1" Touchscreen (x 1) - touch-based panel to control a lighting system.

Vision.Net Control Station (x 4) - simple interface for controlling lights during simple events.

Vision.Net Gateway (x 1) - DIN-rail mountable gateway for architectural control of house and stage lights.

Networking Node 3 (x 2) - configurable 3-port node for DMX-over-IP and Vision.Net bridging.

Contact 24 Relay Panel (x 1) - modular panel providing relay-controlled 120V power to fixtures.

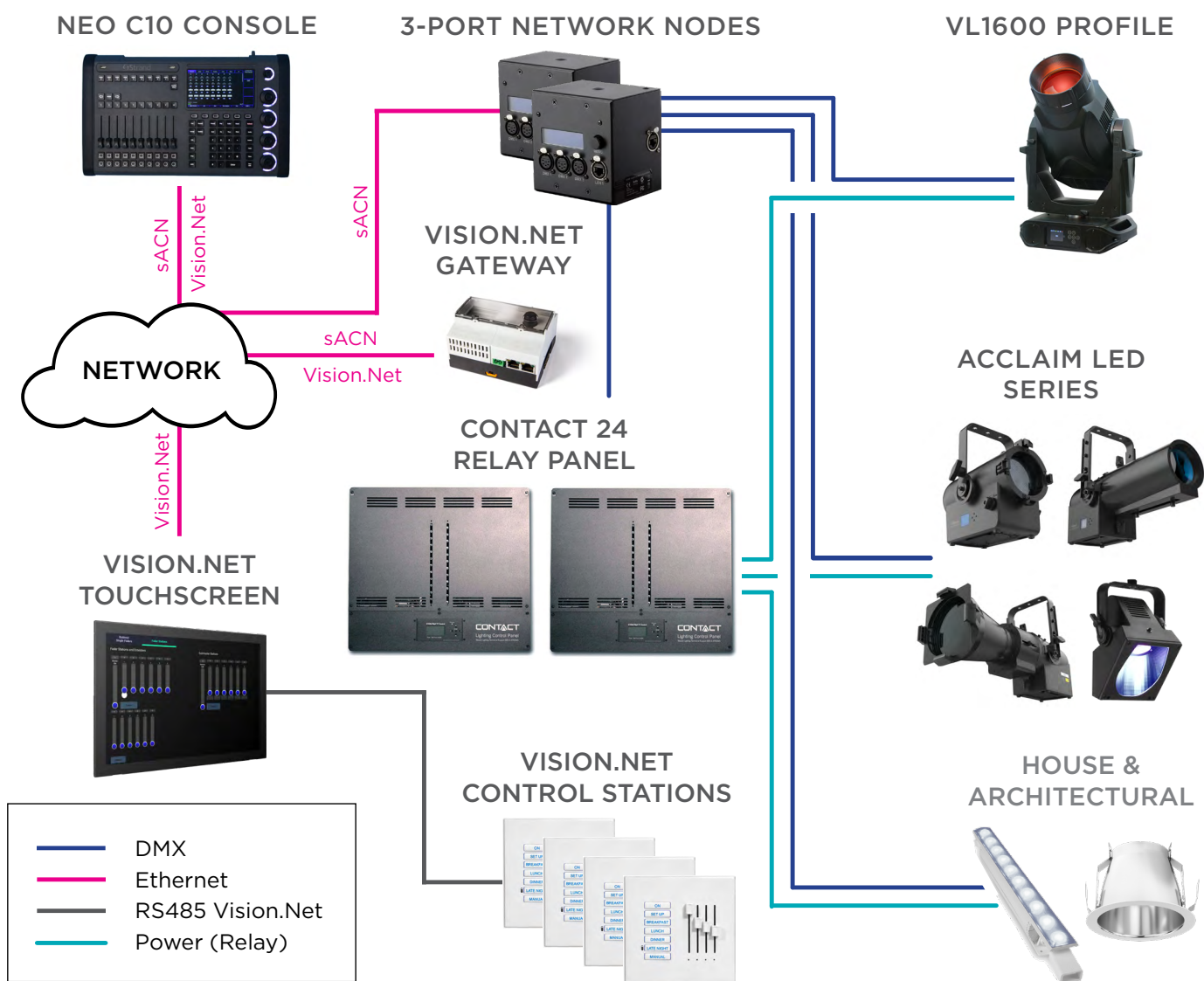

CONNECTIVITY (230V)

FLX Console (x 1) - intuitive lighting console with familiar, industry-standard syntax.

Vision.Net 10.1" Touchscreen (x 1) - touch-based panel to control a lighting system.

Vision.Net Control Station (x 4) - simple interface for controlling lights during simple events.

Vision.Net Gateway (x 1) - DIN-rail mountable gateway for architectural control of house and stage lights.

Networking Node 3 (x 2) - configurable 3-port node for DMX-over-IP or Vision.Net bridging.

RigSwitch 24 Relay Panel (x 2) - modular panel providing relay-controlled 230V power to fixtures.

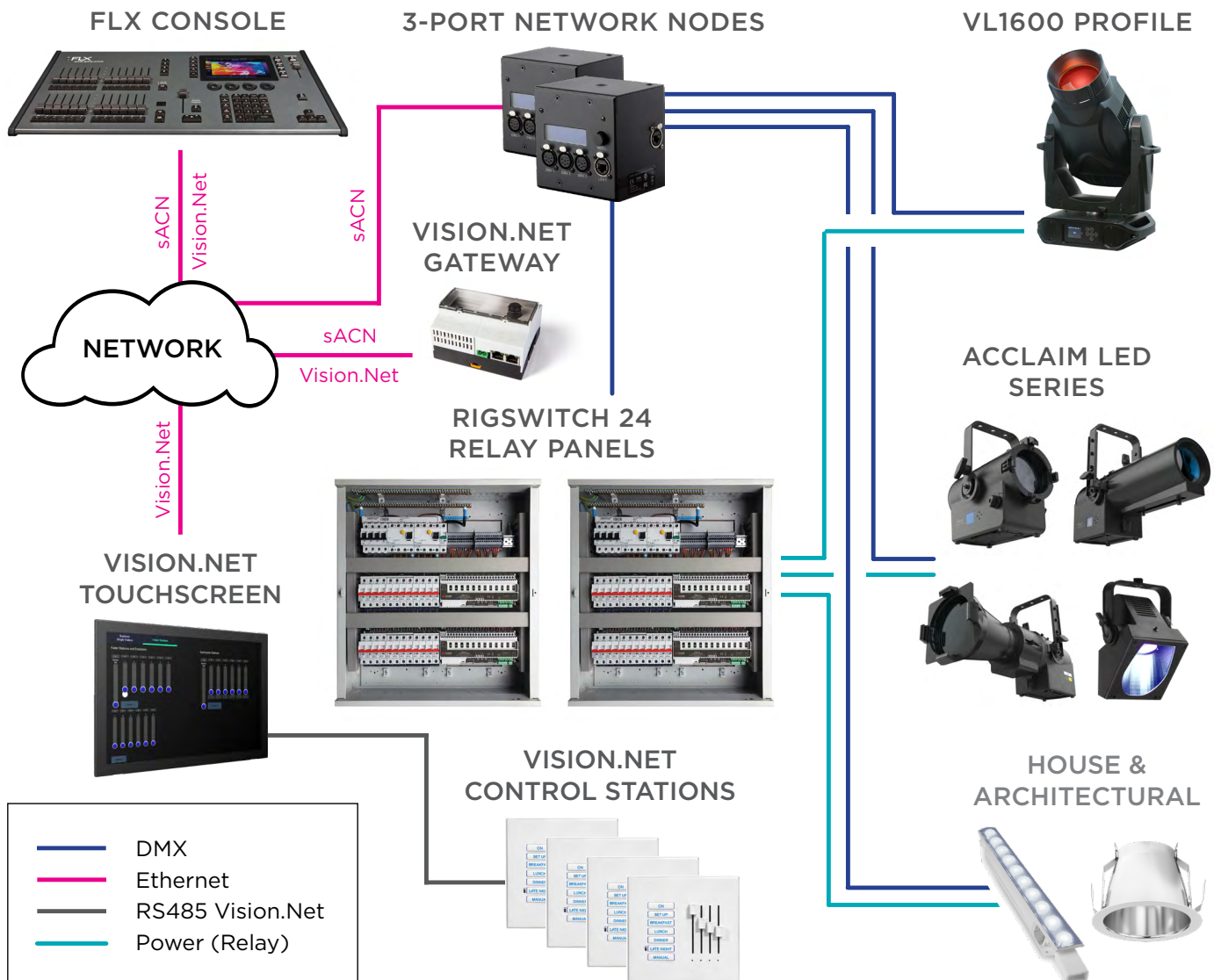

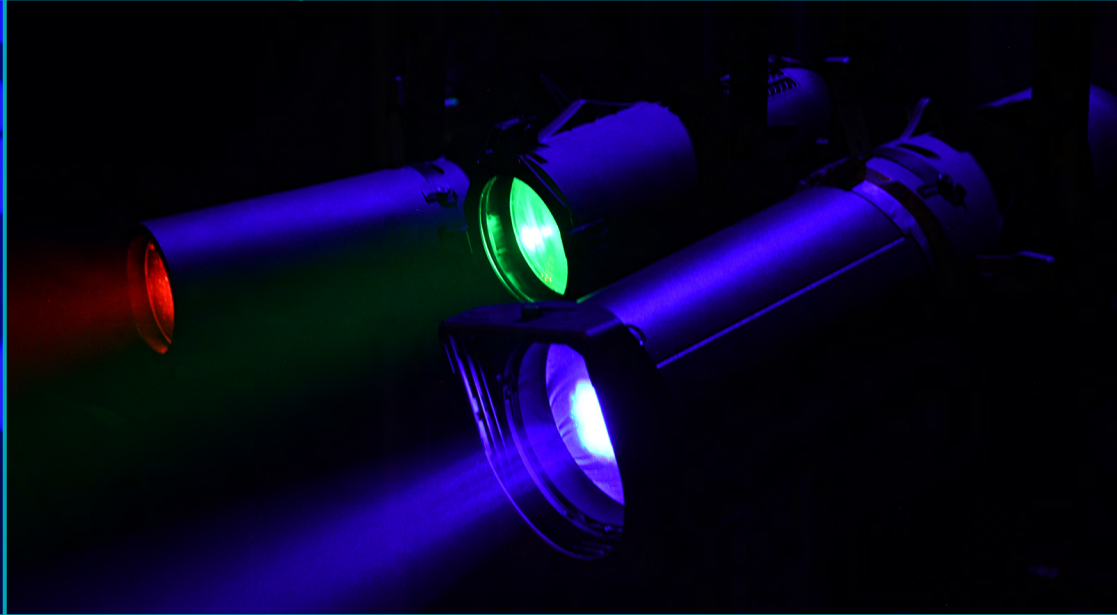

VARI-LITE

©2023 Signify Holding. All rights reserved. All trademarks are owned by Signify Holding or their respective owners. The information provided herein is subject to change, without notice. Signify does not give any representation or warranty as to the accuracy or completeness of the information included herein and shall not be liable for any action in reliance thereon. The information presented in this document is not intended as any commercial offer and does not form part of any quotation or contract, unless otherwise agreed by Signify. Data subject to change.

VARI-LITE

www.vari-lite.com

April 05, 2023